

HY-C0801

CEILING MOUNT BRACKET



The HY-C0801 Ceiling Mount Bracket is designed to mount the speaker system to a ceiling in conjunction with the optional speaker mount bracket.

Key features

Specifications

| | |
|-----------------------|--|
| Compatible Speaker | ES-0851, HS-120B, HS-150B, HS-1200BT, HS-1500BT |
| Maximum Load Capacity | 32 kg (70.55 lb) |
| Finish | Rolled steel plate, black, semi-gloss, paint |
| Weight | 1.9 kg (4.19 lb) |
| Included Accessories | Speaker mounting bolt (with washer) 4 |
| Optional Accessories | Mounting bracket: HY-0851ST, HY-0852ST, HY-1200HB, HY-1200VB, HY-1500HB, HY-1500VB |

Dimensions

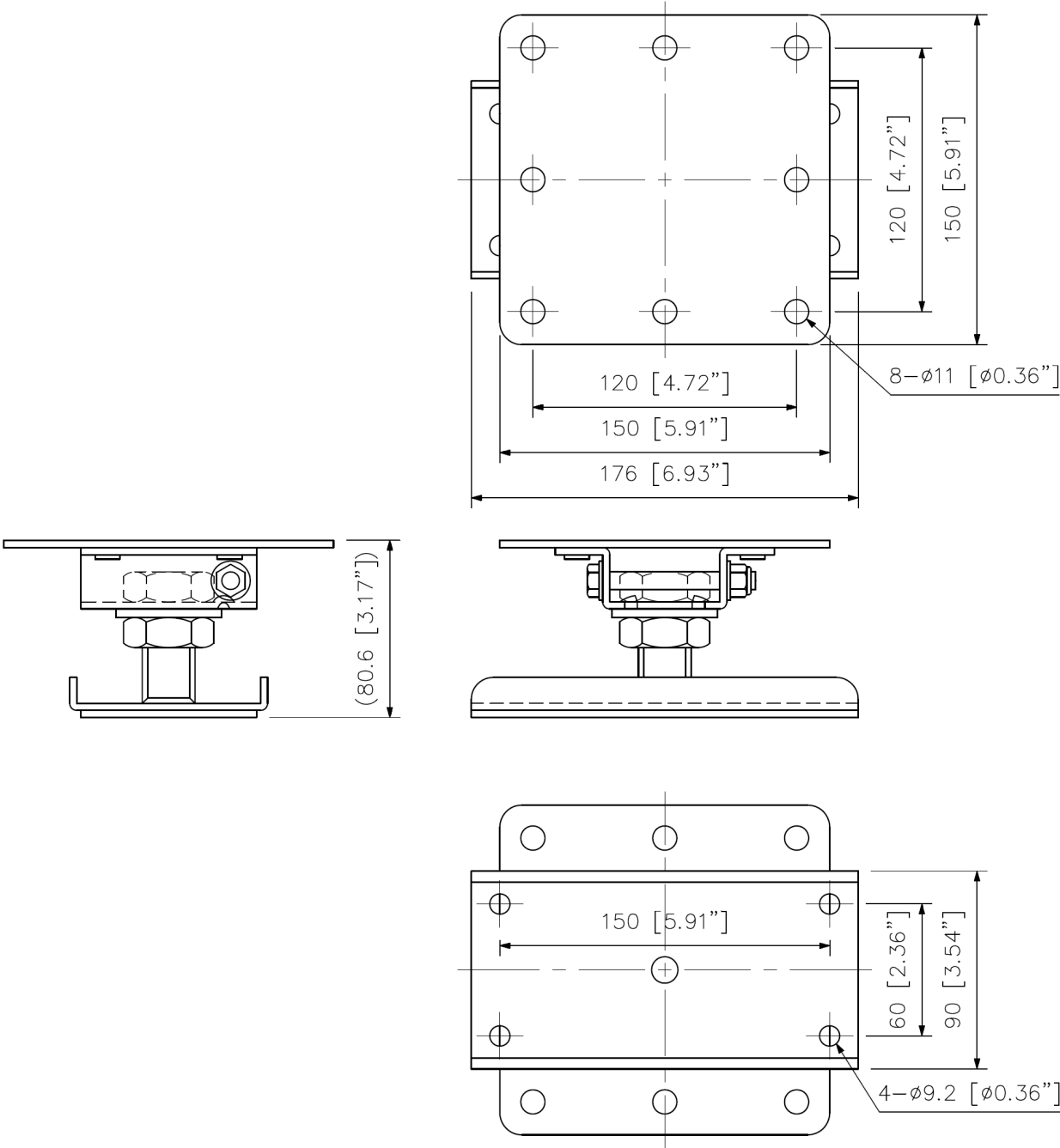

UNIT: mm

Note: Numerical values in parentheses are for reference only.

A&E specifications

UNDEFINED TEXT